

Area of Application

ESSVE Blind rivet is a very useful fastener that gives designers immense variation opportunities in product design and material selection.

Description

ESSVE Blind rivet is easy to fit using hand tools or pneumatic tools, it gives a strong, vi-

bration-proof joint with low-on-site costs.

Installation

ESSVE Blind rivet is mounted from one side of the work piece, in drilled or punched holes that should be approx. 0.1 mm larger than the rivet diameter.

Ø mm	Shear stress N	Tensile load N
3.2	500	700
4.0	850	1200
4.8	1200	1700
5.0	1400	2000
6.4	2200	3150

All strength data are average values and are produced from test series and rivet quantity. We recommend that you use these values only as a guide, since many factors other than strength values can affect the riveting result. We recommend that you also test the rivet in your own application to determine the exact function.

Specification

	Rivets	Mandrel
Material	Aluminium EN AW 5154	Bright galvanised steel
Corrosion categories	C2	

Open blind rivet alu/steel, pan head

Type AL/ST DIN 7337

Item no.	Dimension d x L mm		Grip area mm	dk mm	k mm	dm mm	Rec. drill mm	ESSBOX size	Qty/ pack.	Pack. / large pack.
62201	3.2 x 6.0	1.5 - 3.5	6.5	0.8	1.9	3.3	204	975	6	
62203	3.2 x 8.0	3.0 - 5.5	6.5	0.8	1.9	3.3	204	1000	6	
62205	3.2 x 10.0	5.0 - 7.5	6.5	0.8	1.9	3.3	204	825	6	
62207	3.2 x 12.0	7.0 - 9.0	6.5	0.8	1.9	3.3	204	750	6	
62209	3.2 x 16.0	9.0 - 12.5	6.5	0.8	1.9	3.3	204	625	6	
62211	3.2 x 18.0	10.0 - 14.5	6.5	0.8	1.9	3.3	304	800	4	
62213	3.2 x 20.0	13.0 - 16.5	6.5	0.8	1.9	3.3	304	750	4	
62215	4.0 x 6.0	1.0 - 3.5	8.0	1.0	2.2	4.1	204	700	6	
62217	4.0 x 7.0	3.0 - 4.5	8.0	1.0	2.2	4.1	204	650	6	
62219	4.0 x 8.0	3.0 - 5.5	8.0	1.0	2.2	4.1	204	625	6	
62221	4.0 x 10.0	5.0 - 7.0	8.0	1.0	2.2	4.1	204	600	6	
62223	4.0 x 12.0	6.5 - 9.0	8.0	1.0	2.2	4.1	204	525	6	
62225	4.0 x 14.0	8.5 - 11.0	8.0	1.0	2.2	4.1	204	500	6	
62227	4.0 x 16.0	8.5 - 12.5	8.0	1.0	2.2	4.1	304	700	4	
62229	4.0 x 18.0	12.0 - 14.5	8.0	1.0	2.2	4.1	304	650	4	
62231	4.0 x 20.0	12.5 - 16.0	8.0	1.0	2.2	4.1	304	625	4	
62235	4.8 x 6.0	1.0 - 3.0	9.5	1.2	2.7	4.9	204	475	6	
62237	4.8 x 8.0	2.5 - 5.0	9.5	1.2	2.7	4.9	304	750	4	
62239	4.8 x 10.0	4.0 - 6.5	9.5	1.2	2.7	4.9	304	675	4	
62241	4.8 x 12.0	6.0 - 8.0	9.5	1.2	2.7	4.9	304	650	4	
62243	4.8 x 14.0	7.5 - 10.0	9.5	1.2	2.7	4.9	304	600	4	
62245	4.8 x 16.0	8.0 - 12.0	9.5	1.2	2.7	4.9	304	550	4	
62247	4.8 x 18.0	11.5 - 13.5	9.5	1.2	2.7	4.9	304	525	4	
62249	4.8 x 20.0	12.0 - 15.5	9.5	1.2	2.7	4.9	204	275	6	
62251	4.8 x 22.0	15.0 - 17.5	9.5	1.2	2.7	4.9	204	250	6	
62253	4.8 x 25.0	15.0 - 20.5	9.5	1.2	2.7	4.9	204	225	6	
62255	4.8 x 28.0	20.0 - 23.0	9.5	1.2	2.7	4.9	304	325	4	
62257	4.8 x 30.0	20.0 - 25.0	9.5	1.2	2.7	4.9	304	300	4	
62259	4.8 x 35.0	24.5 - 29.5	9.5	1.2	2.7	4.9	304	275	4	

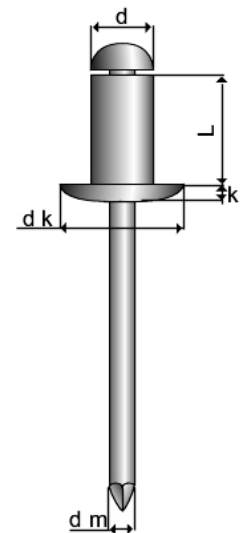

Item no.	Dimension d x L mm	Grip area mm	dk mm	k mm	dm mm	Rec. drill mm	ESSBOX size	Qty/ pack.	Pack. / large pack.
62261	5.0 x 6.0	1.0 - 3.0	9.5	1.2	2.7	5.1	304	675	4
62263	5.0 x 8.0	2.5 - 5.0	9.5	1.2	2.7	5.1	304	775	4
62265	5.0 x 10.0	4.0 - 6.5	9.5	1.2	2.7	5.1	304	675	4
62267	5.0 x 12.0	6.0 - 8.0	9.5	1.2	2.7	5.1	304	625	4
62269	5.0 x 14.0	7.5 - 10.0	9.5	1.2	2.7	5.1	304	525	4
62272	5.0 x 16.0	8.0 - 12.0	9.5	1.2	2.7	5.1	304	500	4
62274	5.0 x 18.0	11.5 - 13.5	9.5	1.2	2.7	5.1	304	450	4
62275	5.0 x 20.0	12.0 - 15.5	9.5	1.2	2.7	5.1	204	250	6
62277	6.4 x 12.0	2.5 - 7.0	13.0	1.8	3.8	6.5	304	325	4
62279	6.4 x 16.0	6.0 - 11.0	13.0	1.8	3.8	6.5	304	300	4
62281	6.4 x 20.0	10.0 - 14.5	13.0	1.8	3.8	6.5	304	250	4
62283	6.4 x 25.0	14.0 - 19.0	13.0	1.8	3.8	6.5	304	225	4
62286	6.4 x 30.0	18.0 - 24.0	13.0	1.8	3.8	6.5	304	225	4